

# FENTON

InnovateElevate

## FORD TRANSIT 140

Medium Top Passenger Side  
Shoulder Belt Bracket Installation

TMTSBPS

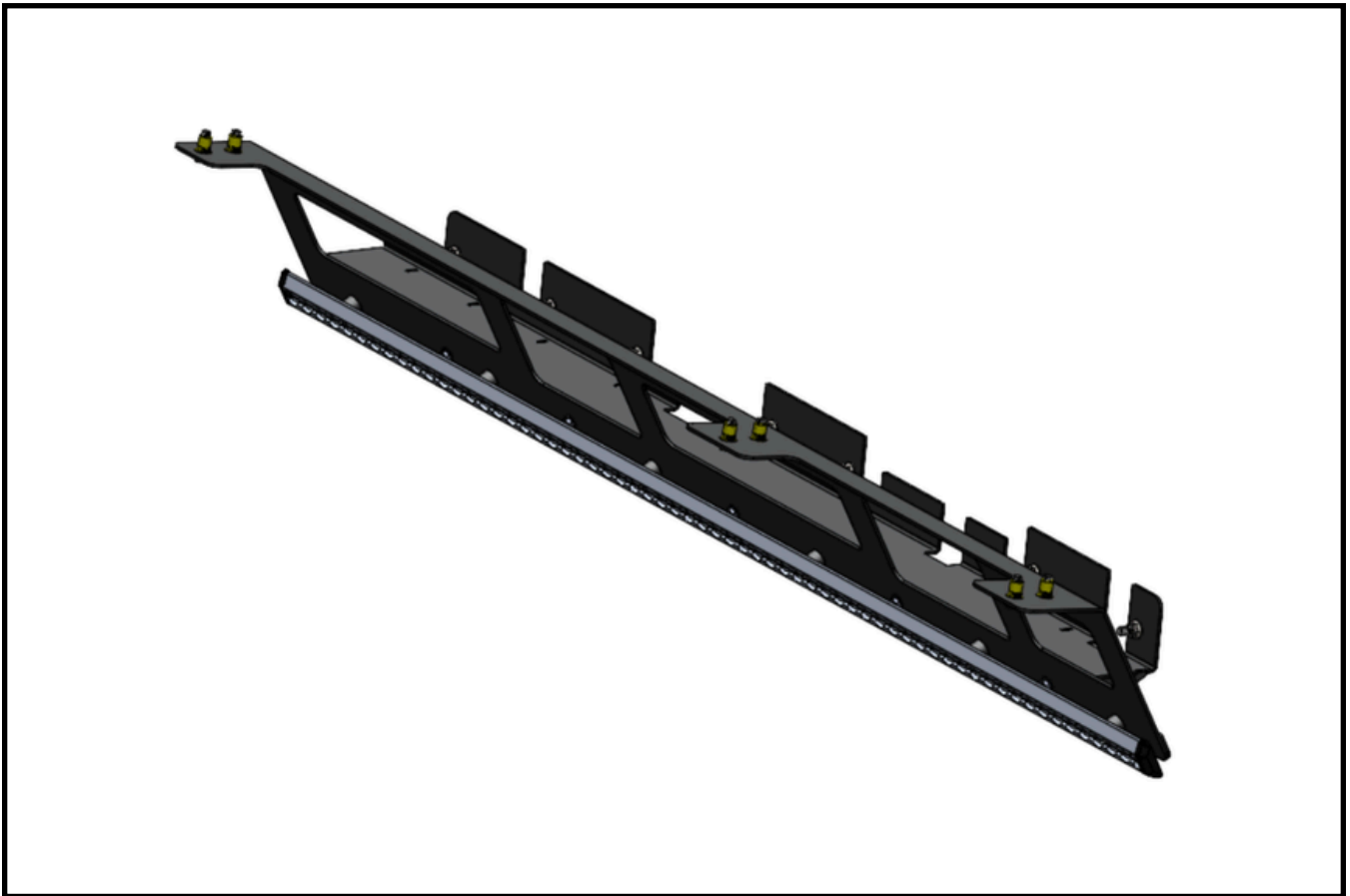

V2026.1

### **INCLUDED IN THIS KIT:**

- (1) Transit 140 Medium Top Passenger Shoulder Bracket Inner Weldment (TMTSBPS-G02)
- (1) Transit 140 Medium Top Passenger Shoulder Bracket Outer Plate (TMTSBPS-P1)
- (5) 1/4"-20 X 0.75" Hex Head Flange Bolt (HF25200758)
- (7) Rivet Nut, 3/8"-16 x .680" (RNRF371669)
- (13) Hex Flange Bolt, 3/8"-16 x 1" (HF3816100Z)
- (6) Hex Flange Nut, 3/8"-16 Serrated (HF3716SRZN)
- (1) Transit Medium Top Shoulder Belt L-Track 63" (TMTSBPS-P4)
- (6) Transit Medium Top Shoulder Belt Bracket Spacer Tube (TMTSBPS-P5)
- (6) Flat Head Socket Screw, 3/8"-16x2" (FHSS371620)
- (2) L-Track Plastic End Cap (SBQSTPEC)

### **NEEDED FOR INSTALLATION:**

- Trim Clip Pliers, 45°
- Marker
- Drill
  - 17/32" bit
    - Use drill stops for all bits to avoid damaging outside wall of vehicle
  - Step cone drill bit
- Single Step Primer
- Wool Dauber Ball Brush
- Air compressor/manual Rivet Nut Tool
- Impact Driver
  - 9/16" socket
  - 3/8" socket
  - 7/32" hex bit
- (5) 3/8" Dowel Screws
- Vice Grip
- Utility knife

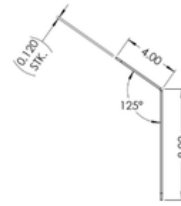
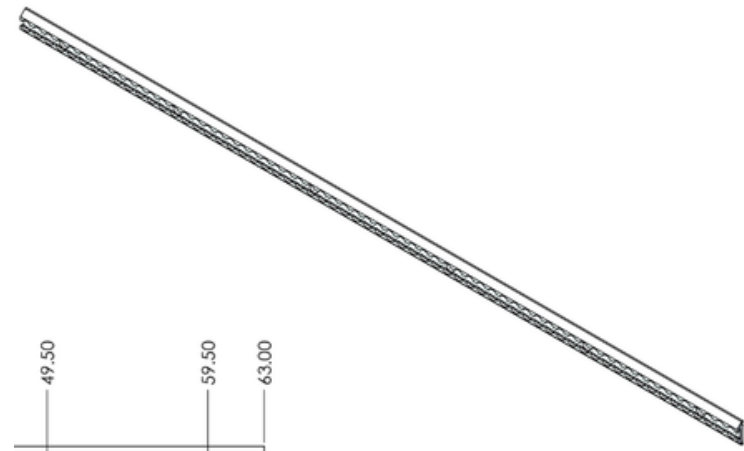
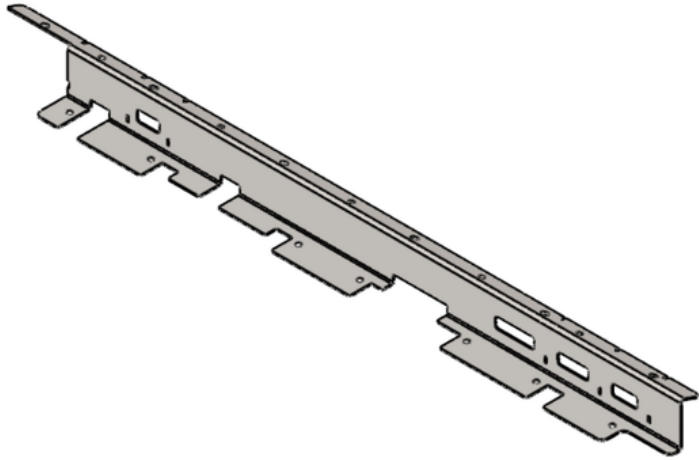
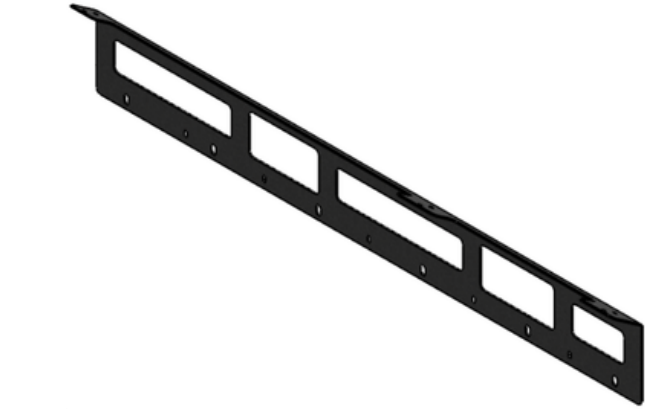

DETAIL A  
SCALE 2:9

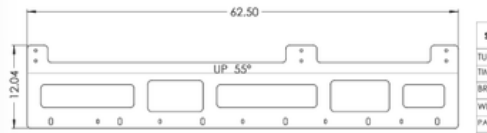
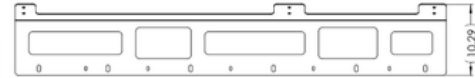

FLAT PATTERN

SEK  
TUM  
TIME  
BRAI  
WIRE  
PAIN  
FAB

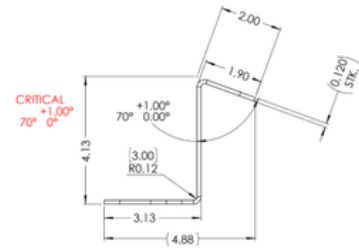

DETAIL A  
SCALE 1:2

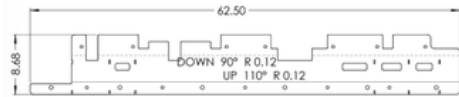

FLAT PATTERN

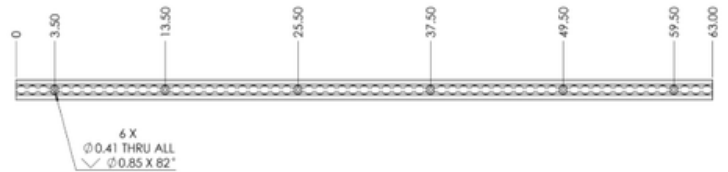



### 1.

Prepare area for installation.

#### NOTE:

A) Remove air conditioning duct.

B) Displace wire harness and remove black corresponding clasps with trim clip pliers.

### 2.

Position inner weldment and plate mark holes (7) across back with marker.



### 3.

Remove weldment and drill hole for hex flange bolt with 5/16" (0.3125") bit.



**4.**

Redrill foremost hole again with 17/32" bit.

**5.**

Swipe single step primer in and around all drilled holes with ball brush.

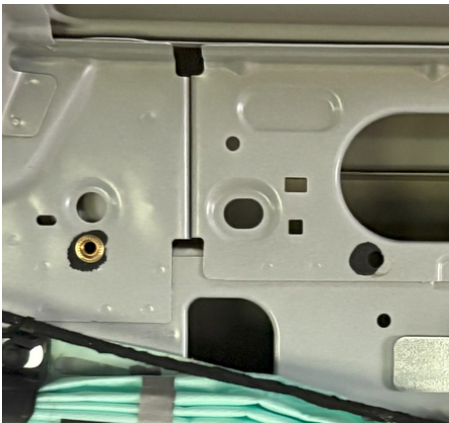

**6.**

Insert rivet nut into first hole and tighten with Air compressor/Manual Rivet Nut Tool.

### 7.

Position inner weldment over holes, scooping wire harness onto inner weldment.



### 8.

Insert hex flange bolt into each hole, matching a nut onto the back, and hand tighten.

**NOTE:**

A) The front bolt will insert into the rivet nut.



### 9.

Tighten hex flange bolts with 9/16" socket bit on impact driver.



### 10.

Position outer plate, loosely tighten inner weldment to outer plate by hex head flange bolts, mark six holes along top on ceiling with marker.

### 11.

Remove plate from weldment and drill pilot hole for rivet nuts with 7/32" bit.



### 12.

Insert Rivet Nuts and tighten with rivet nut tool.



### 13.

Replace air conditioning duct.

### 14.

Position outer plate, insert hex head flange bolts (5) in holes along bottom of outer plate and hand tighten.



### 15.

Insert and hand tighten hex flange bolt into holes made in ceiling and rivet nuts.





### 16.

Tighten with 3/8" socket bit on impact driver.

### 17.

Tighten with 9/16" socket on impact driver.



### 18.

Insert and hand tighten dowel screws in 6 holes on bottom of outer plate.



### 19.

Install headliner, pushing dowel screws through.

### 20.

Remove dowel screws with vice grip by pulling through headliner.



### 21.

Cut headliner with utility knife in "X" formation over previous holes.





### 22.

Push spacer tubes through holes, leaving the edge exposed.

### 23.

Fit plastic end caps on to ends of L-Track.



### 24.

Position L-Track with holes over spacer tubes, insert flat head socket screws in holes in L-Track, hand tighten.

## 25.

Tighten with 7/32" hex bit on impact driver.

# FENTON

InnovateElevate

## Have Questions?

—

Our team is ready to help!

info@fentonmobility.com • 716-484-7016



Terms & Conditions

<https://www.fentonmobility.com/terms-conditions/>