

FENTON

InnovateElevate

FORD TRANSIT 140

AbiliTrax Shift-N-Step Full
Floor Track System Installation

AAT4Z0NS

For use with Fenton's custom Transit Drill Template (AAT140DT)

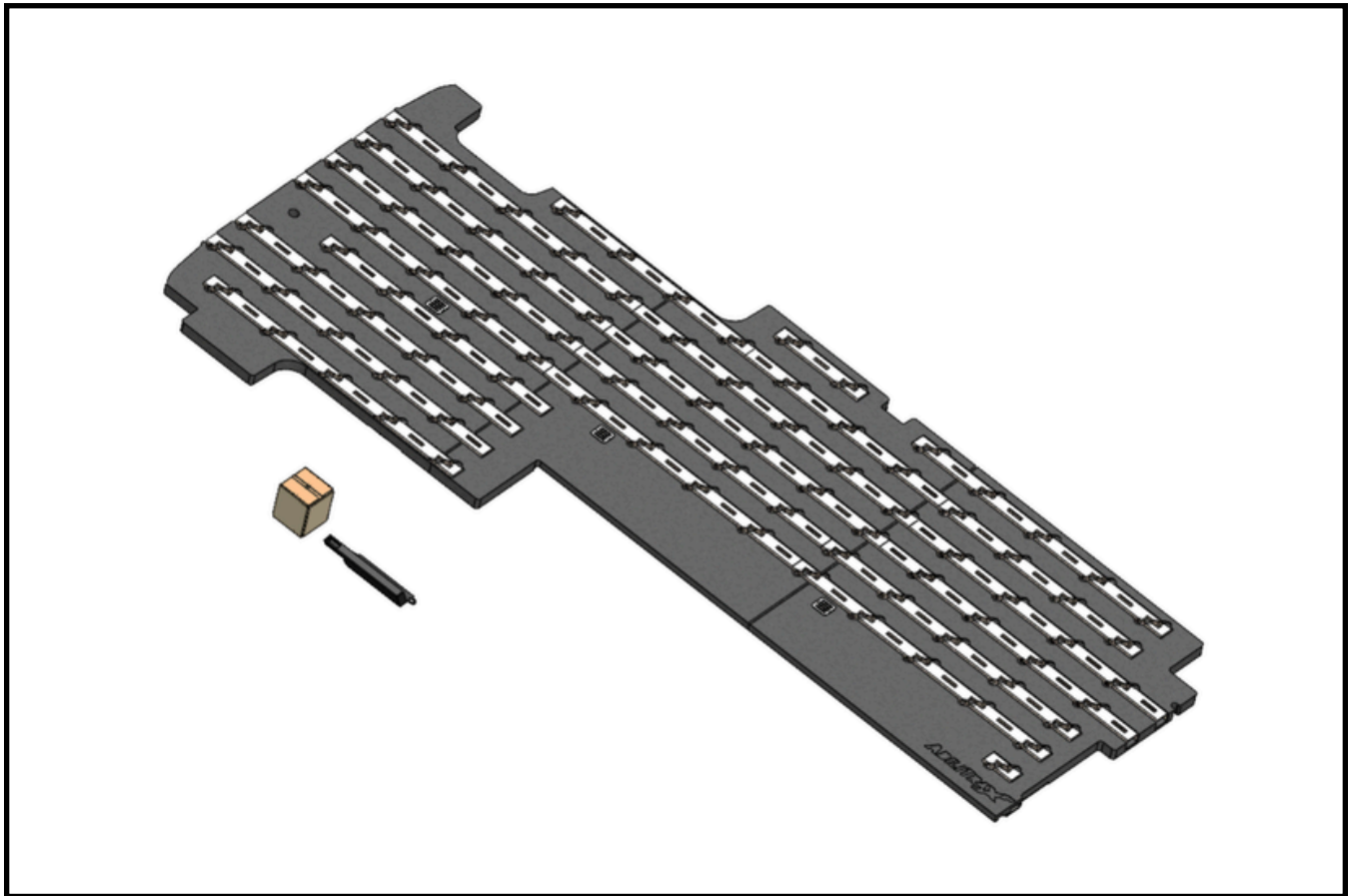

INCLUDED IN THIS KIT:

- (1) Transit 140 Shift-N-Step Front Floor Pod (AAT4Z0NS P1)
- (1) Transit 140 Shift-N-Step Mid Floor Pod (AAT4Z0NS P1)
- (1) Transit 140 Shift-N-Step Rear Floor Pod (AAT4Z0NS P3)
- (1) Transit 140 Shift-N-Step Rear Cross Plate (AAT4Z0NS-P3)
- (1) Transit 140 Shift-N-Step Wheel Well Cross Plate (AAT4Z0NS-P4)
- (1) Transit 140 SNS Mid Cross Plate (AAT4Z0NS-P5)
- (2) Transit 140 Shift-N-Step Front Cross Plate (AAT4Z0NS-P6)
- (1) Transit 140 Shift-N-Step Heat Channel Bottom (AAT4Z0NS-P14)
- (3) Vent Cover (ATHVCP00)
- (1) Shift-N-Step Heat Vent Adapter (AAT4Z0NS-HVA-G01)
- (1) Transit 140 Shift-N-Step Laser Cut Rail Kit (AAT4Z0NSLRK)
- (1) Transit 140 Shift-N-Step Kit (FASTENAL #10263-06639) (AAT4ZHW00K)

Kit Part # 10263-06639 **AAT4ZHW00**

of Kits 5

<u>Part #</u>	<u>Customer Part #</u>	<u>Description</u>	<u>Qty/Kit</u>	✓	Total
0115115	HH37163008	HCS 3/8-16 x 3 YZ8	2		10
0115117	HH37163508	HCS 3/8-16x3 1/2 YZ8	3		15
0115123	HH37165008	HCS 3/8-16 x 5 YZ8	3		15
15127	HH37167008	HCS 3/8-16 x 7 YZ8	3		15
14135	HH37161108	HCS 3/8-16 x 11 P8	4		20
1137337	FN2520SRZN	1/4"-20 Flange Nut	4		20
1129583	FHP252030Z	1/4"-20 x 3" FPhMS	4		20
0115121	HH37164508	HCS 3/8-16x4.5 YZ8	5		25
0115113	HH37162508	HCS 3/8-16x2.5 YZ8	7		35
15126	HH37166508	HCS 3/8-16 x 6.5 YZ8	10		50
94095	BH37161758	BHSCS 3/8-16X1 3/4 Z	10		50
0115111	HH37162008	HCS 3/8-16 x 2 YZ8	42		210
0167009	FN3716TLK8	3/8-16FIngTopLkGrG Z	89		445
1133815	FW03750628	SAE THRU-HARD 3/8 YZ	89		445
921036421	FWB3720012	.391X2.0X.125 FW YZ	83		415
10263-07194	FWCB3720012	D-Clipped FW 2"x.390x.120	16		80

NEEDED FOR INSTALLATION:

- Impact Driver
 - 15mm socket
 - 3/8" socket
 - 24" long 12mm square bit
 - 7/16" socket
 - Philips head
 - Allen wrench
- Pneumatic Air Hammer
 - chisel
- Marker
- Sawzall
 - Sawzall blade for cutting metal
- (2) 1/4"-20 x 5/8" Zinc Finish Case Hardened Hex Serrated Flange Bolt (HF25200625)
- (2) 1/4"-20 18-8 Stainless Steel Serrated Flange Nut (FN2520SRSS)
- Single step primer
- Floor Bolt Templates
- (12) #8-18 x 1-5/8" Phillips Drive Self-Drilling Screw (MTH818162SD)
- Drill
 - 3/16"-7/8" step cone drill bit
 - 1/4" drill bit
 - 1-1/2" hole saw bit
 - 12" long 7/16" drill bit
 - 23/64" bit
- Vacuum/Broom/Blow Gun
- Rust protectant spray/primer
- (5) #8-18 x 3/4" Phillips Drive Modified Truss/ Round Washer Head Black Oxide Finish #2 Point Steel Self-Drilling Screw (MTH81875BD)
- Awl Pick
- (2) metal rail positioning plates
- (18) Vise-Grip Locking Pliers
- Bolt sizing and placement guide
- (10) 3/8"-16x1-3/4" Button Socket Cap Screw (BH37161758)
- (20) 3/4" x 2.000" OD Thru-Hardened Yellow Zinc Finish Steel USS General Purpose
- Flat Washer (Fastenal Part No. (SKU):[2133864](#))
- (10) 3/8"-16 Grade G Zinc Finish Steel Flange Top Lock Nut (FN3716TLK8)
- 30 ft/lb. Torque stick/wench
 - Air pressurized impact wrench for torque stick
 - 3/8 drive
- 9/16 wrench
- (8) #4-24 x 3/4" Phillips Drive Pan Head Grade 18-8 Type A Point Stainless Steel Sheet Metal Screw (PHSMS42475)
- Measuring Tape
- 2" roll painters tape
- Jigsaw
 - Jigsaw blade for cutting plastic
- (2) 1/4-20 Flanged EZ-LOK Hex Drive Soft Wood Thread Insert (TIHD2520EZ)
- (2) 06220-4A2X20 25mm Dia x 1/4"-20 Thread Form L With External Thread Star Grips (KNOB252020)

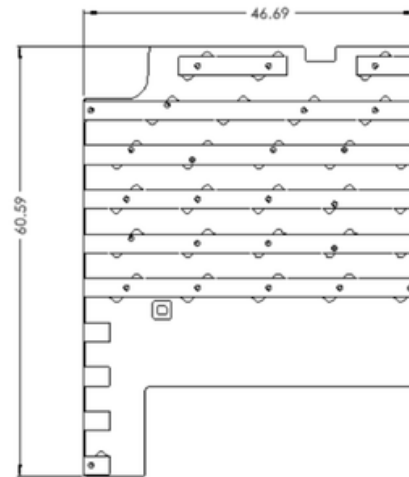
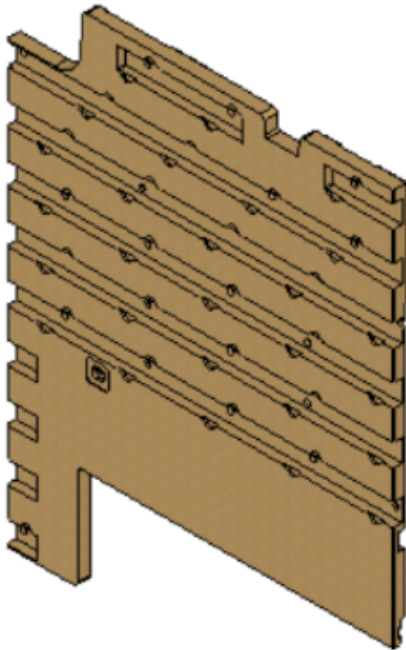
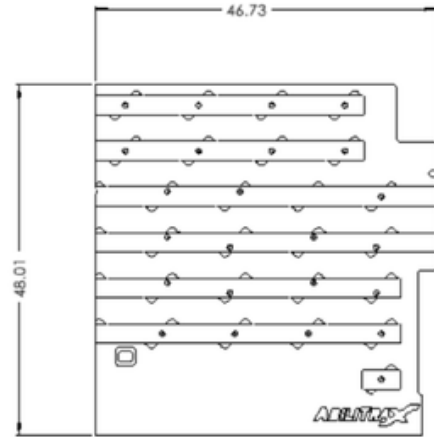
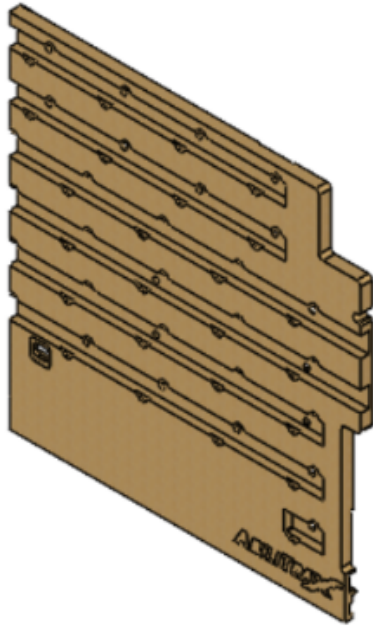

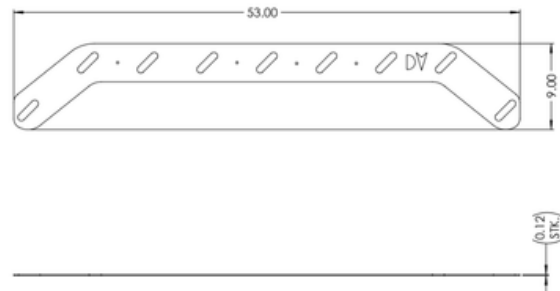
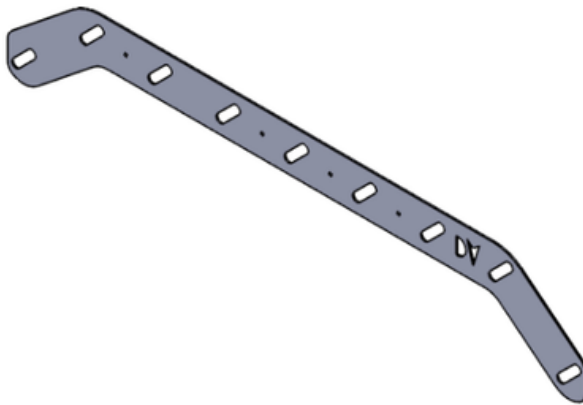
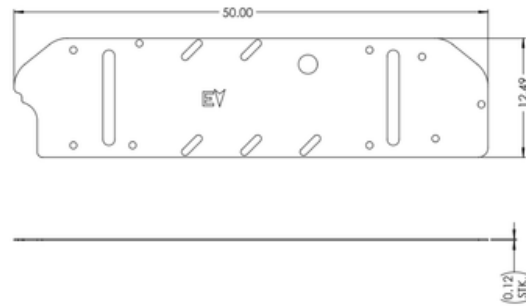
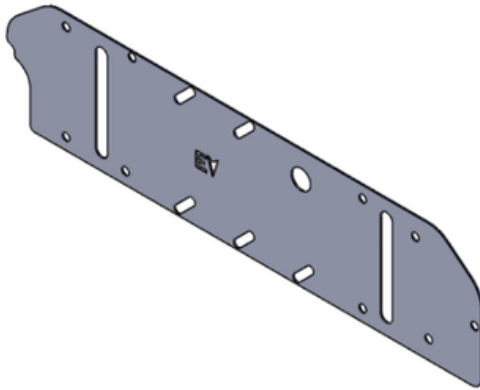
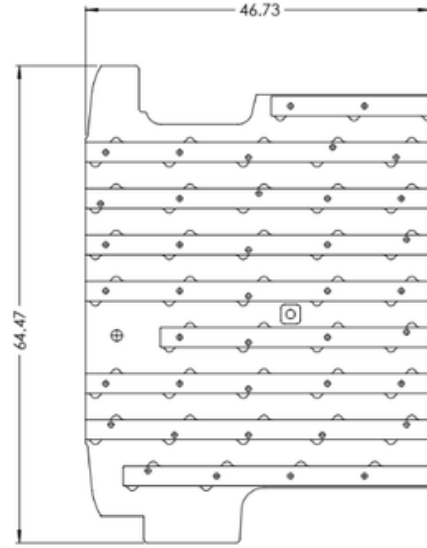
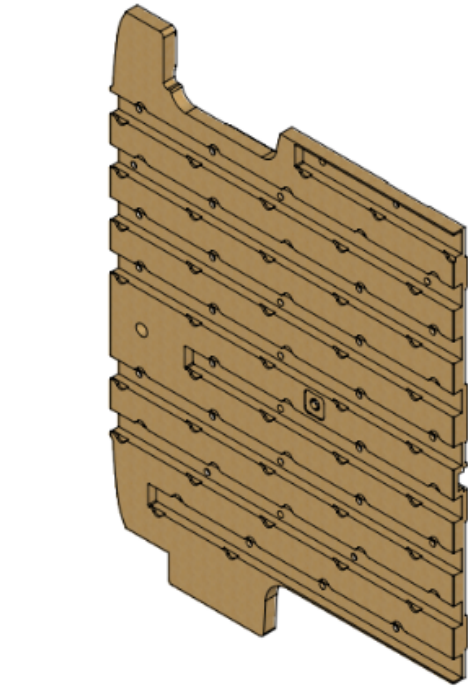

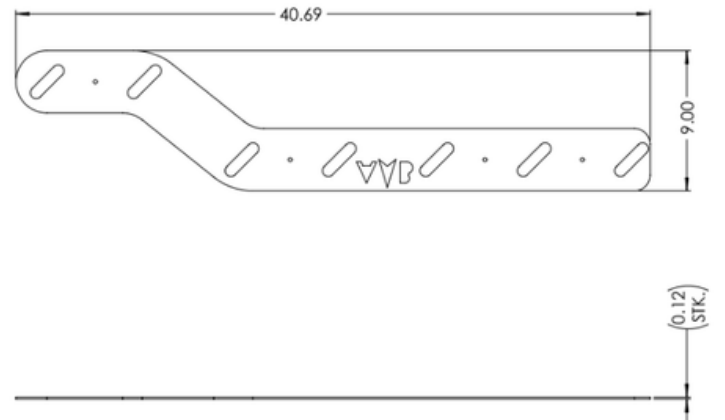
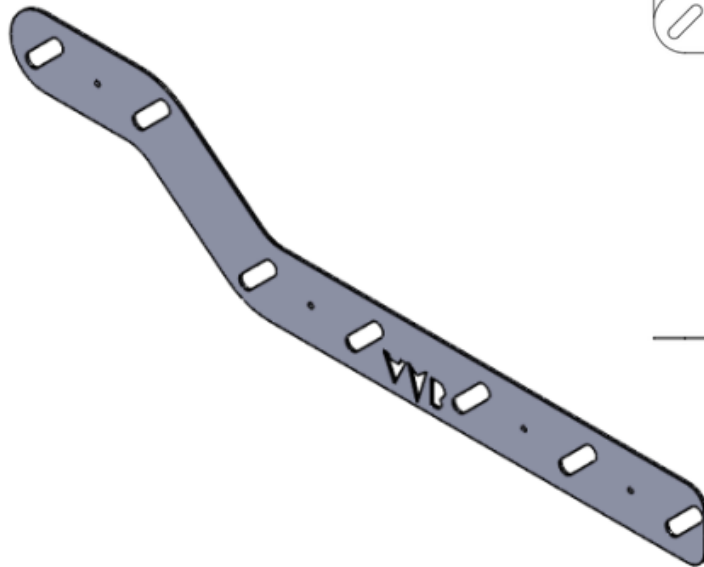
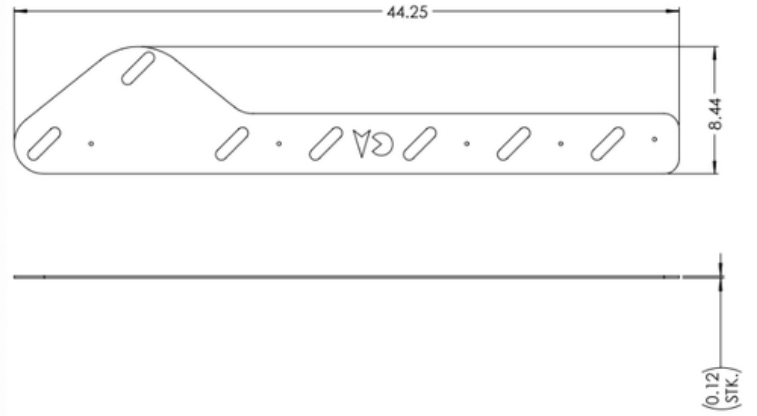
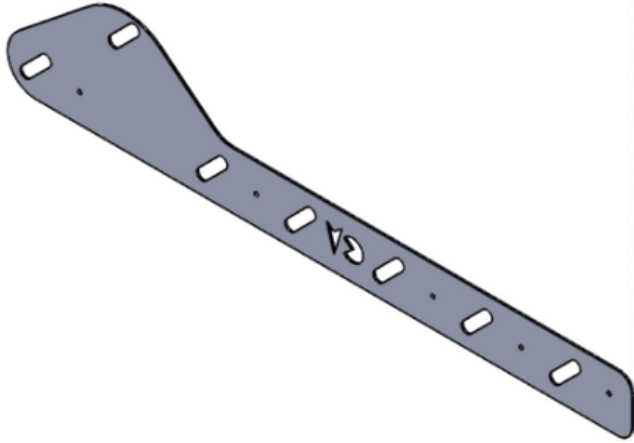

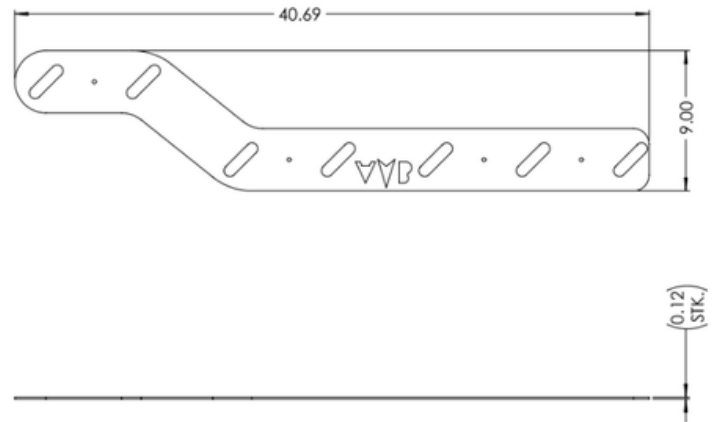
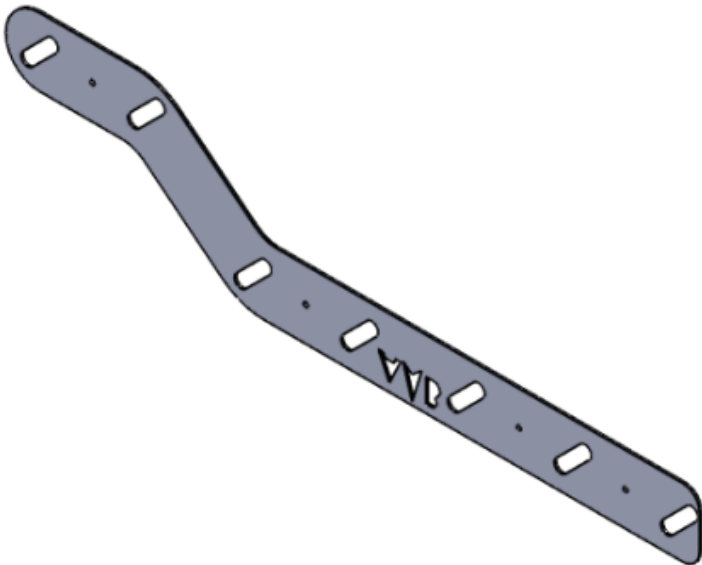
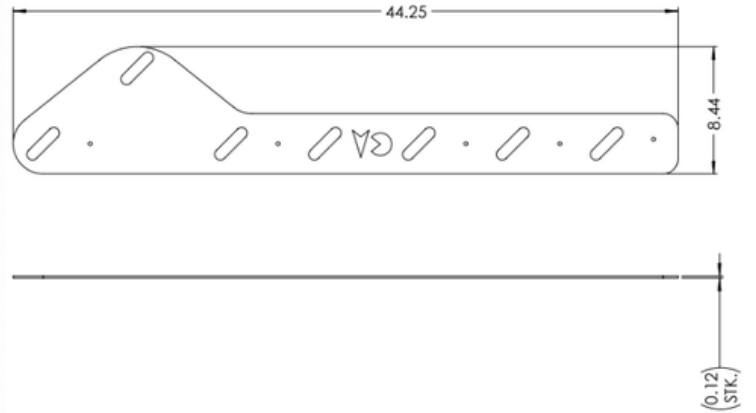
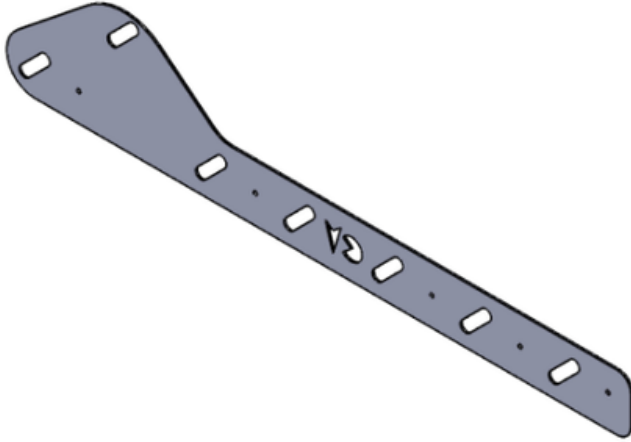



1.

Prepare space/vehicle for installation.

NOTE:

- A) Place vehicle on lift/ramps.
- B) Remove OEM floor and floor tracks.
- C) Remove interior plastic wall covers.

2.

Lower fuel tank onto stand.

NOTE:

- A) Remove hardware and lower lines away from chassis and disconnect the wire harness for fuel pump and fuel level sensor.
- B) Place jack and wooden stand under fuel tank to lower but not completely remove.
- C) Loosen bolts holding fuel tank with 15mm socket bit on impact driver.



3.

Remove spare tire and remove spare tire mechanism.

NOTE:

Do not remove spare tire mechanism if Shift-N-Step is installed.

- A) Insert the 24" long 12mm square bit on impact driver through the access hole in the floor.
- B) Unhook the center cable plate from the middle of the tire.
- C) Remove rivets (4) from metal panel with air hammer with chisel.
- D) Use vise grips to grip the cable and pull free from hanger.
- E) Pull winch unit and cable up through the floor and remove.





4.

Cut and drill removed spare tire mechanism.

NOTE:

Skip if Shift-N-Step is used instead of regular side lift.

A) Mark two dots in center of winch plate on both edges and mark a line on the top portion of plate.

B) Cut marked line with sawzall.

C) Drill bolt holes with 1/4" drill bit.

5.

Continue relocating mechanism by drilling new holes.

NOTE:

The Shift-N-Step mounts different from just a side lift, and the mechanism doesn't interfere with the mounting of an SNS like a side lift would.

A) Mark bolt holes under van so winch plate is centered in preexisting OEM hole. Drill holes with 1/4" bit.

B) Reposition winch and insert bolts into holes.

C) Tighten nut on rear side using 3/8" socket on impact driver.

D) Insert cable into hanger on underside of vehicle.

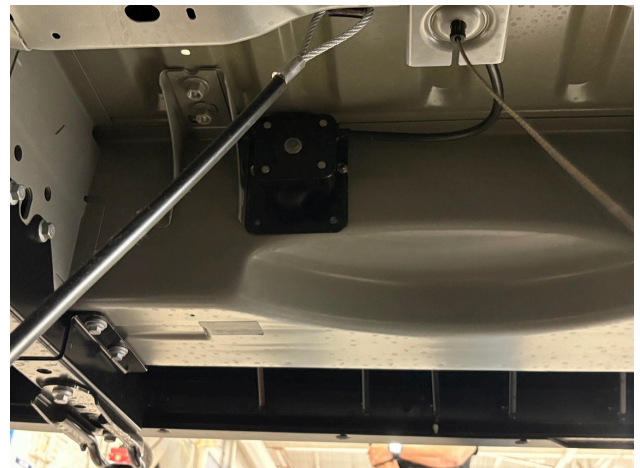

6.

Drill a hole to make an access port for tire release.

NOTE:

With the relocation, a hole needs to be created in order to reach the release nut with the lug wrench.

A) Line up the middle of 1-1/2" hole saw on exterior with where middle of winch is to access the drive mechanism and cut out circle hole.

B) Treat hole with primer and fit with lidded gasket to cover.



7.

Place floor bolt templates on floor (Front first, then driver side, finally passenger side).

NOTE:

A) Fit interlocking pieces together like puzzle.

B) Center template on floor and flush with back edge of chassis.

8.

Secure templates to van floor with self-drilling screws and Phillips head bit on impact driver in locations marked on drill template.

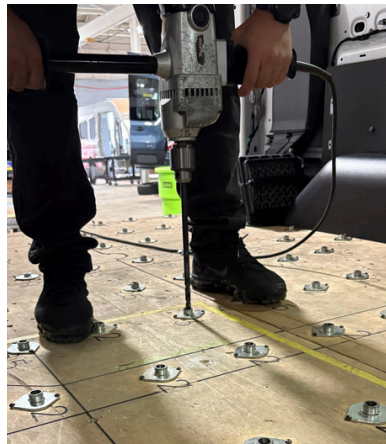
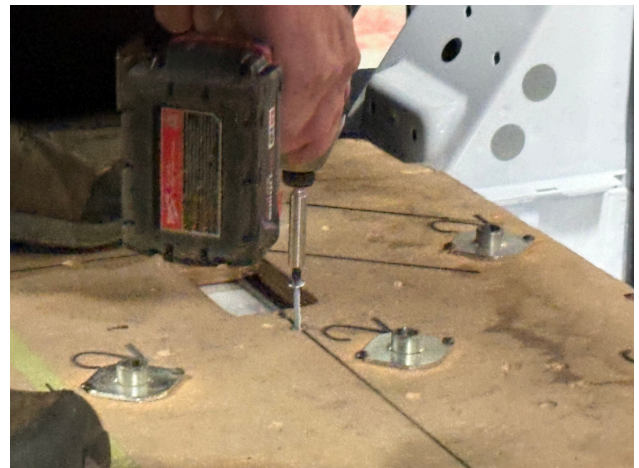

9.

Use drill and 7/16" bit to drill holes through drill bushings according to depth labeled near hole in template.

NOTE:

A) There are components underneath what you are drilling, so be careful not to hit anything critical.

10.

Remove floor bolt templates in reverse order of installation.

NOTE:

A) Passenger first, then driver, finally front.

11.

Vacuum, sweep, and/or blow out debris as needed.



12.

Apply Rust Protectant Spray to each hole drilled.

13.

Place floor pods underside up.

14.

Place cross plates into designed floor pods and tighten #8-18 x 3/4" Phillips Drive Self-Drilling Screws into designated spots with Phillips head bit on impact driver.

NOTE:

A) A/B cross plate in front floor pod.

B) A/B and C cross plates in mid floor pod.

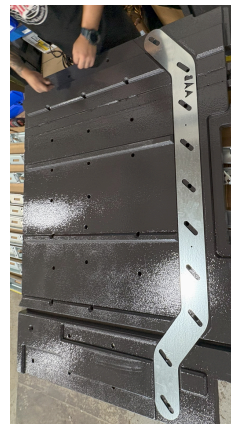

15.

Continue with putting cross plates into floor pods.

NOTE:

C) D cross plate in rear floor pod.

D) E cross plate will be attached later to rear floor pod. Place in correct spot in the rear, but do not attach now.

16.

Position floor pods into vehicle.



17.

Connect rail weldments with 1/4"-20 x 5/8" Hex Serrated Flange Bolt and 1/4"-20 Serrated Flange Nut with 7/16" bit on impact driver with rail size according to rail kit blue print.

NOTE:

- A)** Sizing numbers correspond to number of notches on side of rail plate.
- B)** Insert bolt from "X" side, nut from "-" side, and tighten from "-" side.
- C)** Be sure rails are flush on top and sides of rail, and there is no step or misalignment.

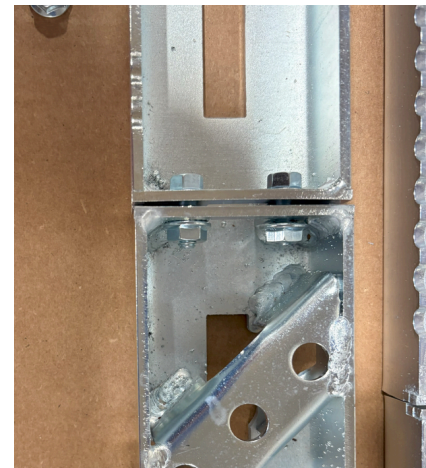

18.

Insert rail weldment assemblies into rail slots in floor pods.

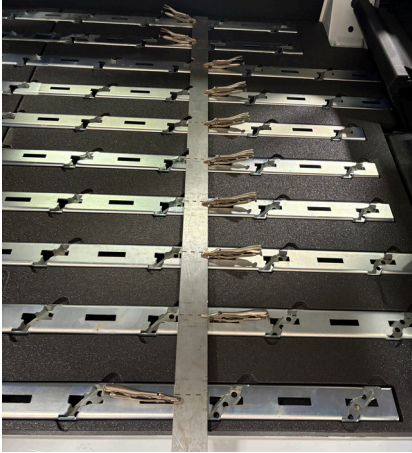

19.

Using awl pick and vise grips, place floor straight edge tool on either end of rail weldment assemblies.

NOTE:

A) Dotted line on plate should be in line with passenger side interior of each slot.

B) Bottom edge of plate should align with top edge of slot.

C) This makes sure the rails are square, and even left to right and front to back. It is critical to maintain 6-1/4" in center.

20.

Secure plates with vise grips (10 on front, 8 on rear).

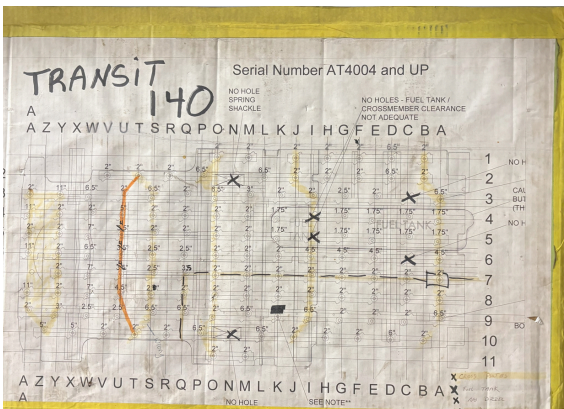

21.

Using the bolt guide, insert each bolt and washer into the drilled hole through each "X" hole and flat washer.

NOTE:

A) On holes marked 1.75" on bolt guide, use 1 3/8"-16 x 1-3/4" Button Socket Cap Screw, 2 2" OD Flat Washers and 1 3/8"-16 Flange Top Lock Nut per hole and insert up through floor.

B) If bolt won't fully seat, pinch and drop repeatedly, wiggle hole with awl pick to realign, and at a last resort, drill hole again with 7/16" bit on regular drill.



22.

Underneath the vehicle, place a 2" OD flat washer and flange nut on underside of each bolt.

NOTE:

A) If full 2" washer doesn't fit flush, use a 1/2" washer

B) Hand tighten as much as possible to avoid nut and washer loosening and falling during tightening.

23.

Hold nut bottom with 9/16" wrench and torque all bolts to 30 ft/lbs maximum.

NOTE:

A) Can create damage if too tight so be careful. However, make sure it is tightened so it doesn't fall off.

B) Washer should be slightly indented into underside of vehicle with no movement.



24.

Check rail height as rails must be flush or level with all corresponding rails.

NOTE:

A) Looking to achieve a flat floor and level rails.



25.

Remove positioning templates.

26.

Stick serial number vinyl on to tag, and secure into front driver side floor corner with #4-24 x 3/4" Phillips Drive Pan Head Screws (2) and Phillips head bit on impact driver.

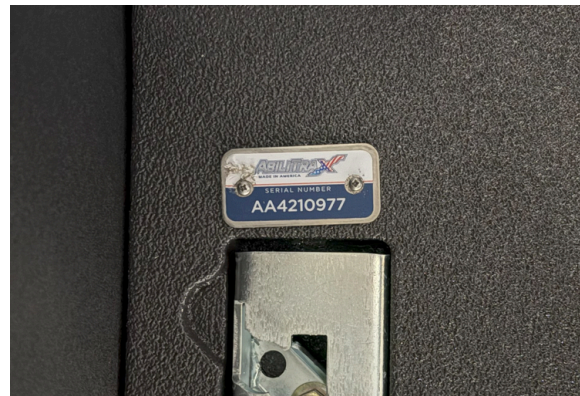

27.

Install vent covers for the floor heating system using #4-24 x 3/4" Phillips Drive Pan Head Screws (2 each).



28.

Measure and mark interior plastic wall covers with 2" tap as guide and straight edge 1" from bottom on right C-pillar, 1-3/8" from bottom on right D-pillar, from bottom on left C-Pillar, and cut the left D-pillar to fit.

29.

Cut with jigsaw to allow space for AbiliTrax flooring underneath.

NOTE:

A) Clean and sand/file cut edge.



30.

Replace all covers in vehicle.



31.

Accessing through lidded gasket on rear, retighten spare tire with 1/2" drive bit on impact driver.

32.

Position rear angle trim on end of floor pod.



33.

Drill pilot hole for wood inserts with 23/64" bit.

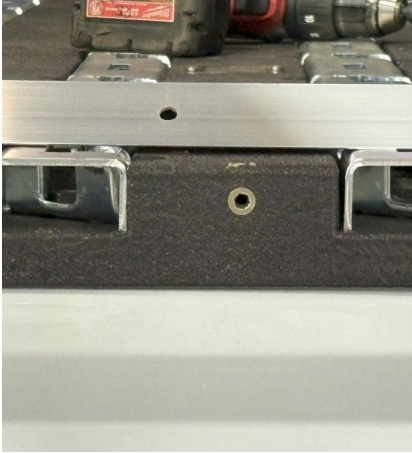

34.

Remove plate, insert and tighten wood inserts with Allen wrench.

35.

Reposition plate and tighten into place with turn out knobs.



FENTON

InnovateElevate

Have Questions?

—

Our team is ready to help!

info@fentonmobility.com • 716-484-7016



Terms & Conditions

<https://www.fentonmobility.com/terms-conditions/>